

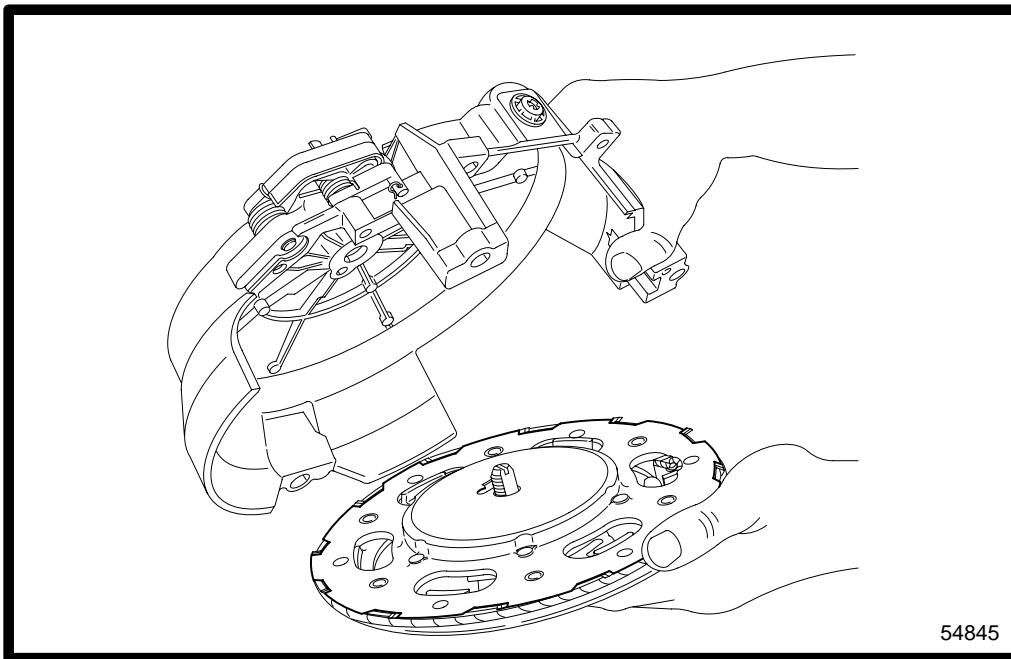

OUTBOARD MOTOR INSTALLATION/ ATTACHMENTS



7
C

REWIND STARTER



Table of Contents

	Page
Rewind Starter Components	7C-1
Torque Specifications	7C-1
Quicksilver Lubricants and Service Aids ..	7C-1
Rewind Starter Disassembly	7C-2
Cleaning and Inspection	7C-3
Rewind Starter Reassembly	7C-4
Installing Used Rewind Spring	7C-4
Installing New Rewind Spring	7C-4
Rope Installation	7C-5
Adjusting Rewind Spring Tension	7C-7



Rewind Starter Components

- 1 - Nut (Left Hand Thread)
- 2 - Tab Washer
- 3 - Starter Housing
- 4 - Starter Sheave
- 5 - Starter Pawl
- 6 - Screw (3)
- 7 - Lockwasher (3)
- 8 - Screw (2)
- 9 - Nut (2)
- 10- Plate
- 11- Spring
- 12- Bushing
- 13- Spring
- 14- "E" Ring
- 15- Spacer
- 16- Washer
- 17- Lever
- 18- Wave Washer
- 19- Sheave Shaft
- 20- Starter Rope
- 21- Handle and Retainer
- 22- Cable
- 23- Screw
- 24- Washer
- 25- Washer
- 26- Screw
- 27- Spring
- 28- Cam
- 29- Screw
- 30- Actuator
- 31- Cotter Pin
- 32- Screw
- 33- Spring
- 34- Bushing
- 35- Retaining Ring
- 36- Rest Assembly
- 37- Seal
- 38- Primer Bulb
- 39- Tubing
- 40- Stop Switch Assembly
- 41- Boot Assembly
- 42- Cotter Pin (2)

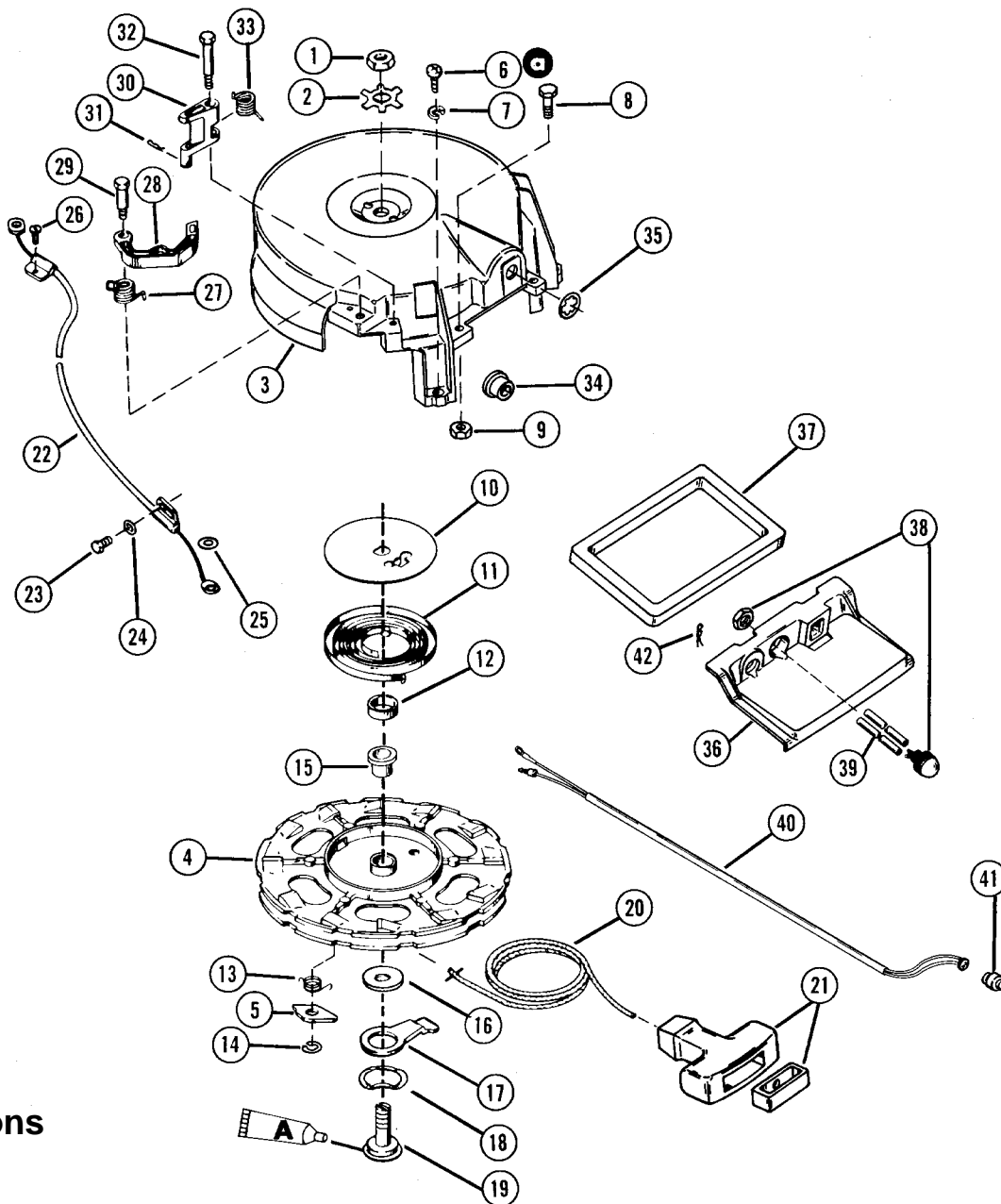

Torque Specifications

- a** 100 lb. in. (11 N·m)

Quicksilver Lubricants and Service Aids

A 2-4-C Marine Lubricant*

*See Quicksilver Accessories Guide for part numbers.



Rewind Starter Disassembly

⚠ WARNING

When disassembling and reassembling rewind starter, **SAFETY GLASSES** must be worn in case rewind spring uncoils out of the housing.

1. Untie knot in starter rope and release starter rope to allow rewind spring to unwind.
2. Remove retaining clip and attaching screw which secures shift interlock cable to starter housing.
3. Remove rewind starter from engine.

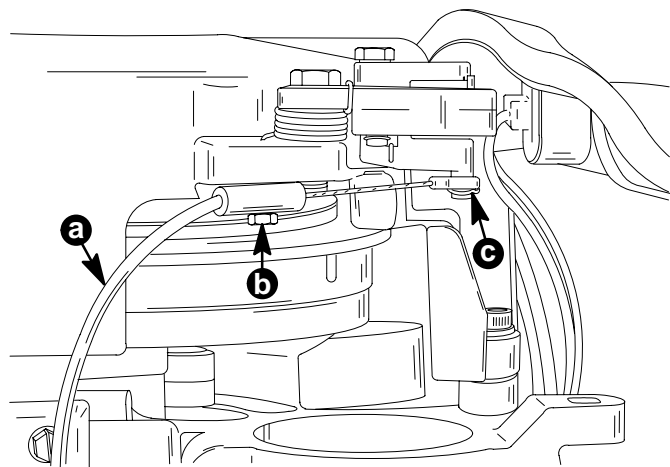

54842

- a - Shift Interlock Cable
- b - Cable Attaching Screw
- c - Retaining Clip

4. Bend lock tabs (a) away from nut (b).
5. Remove nut ("b" left hand thread-turn clockwise to remove) while supporting rewind assembly.

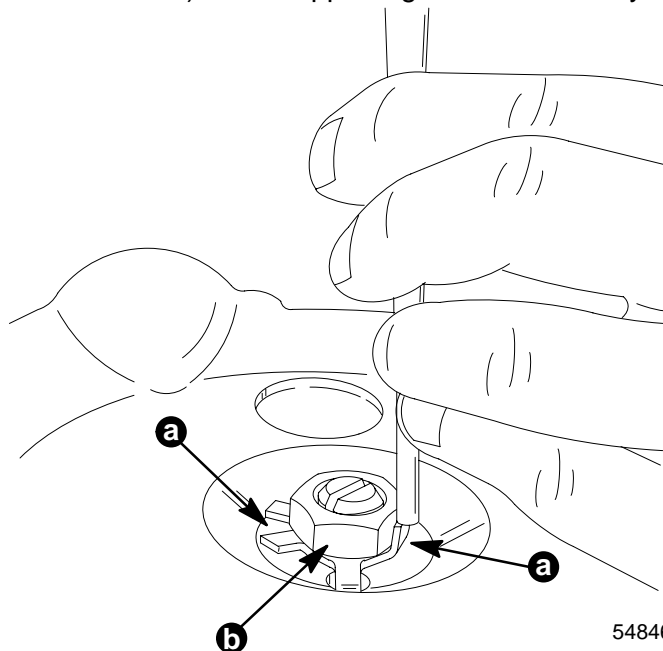

54846

6. Remove sheave assembly (a) from housing.

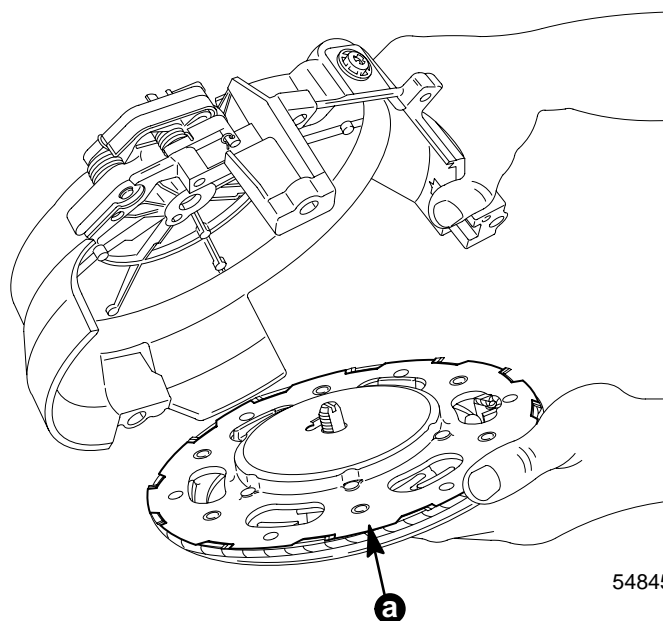

54845



7. Remove spring retaining plate.

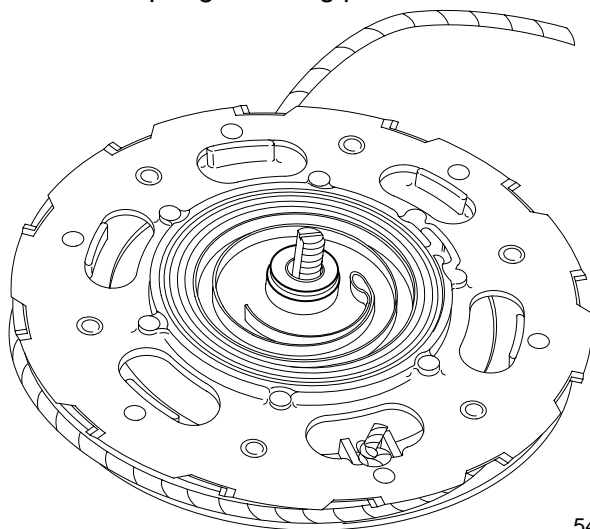

54847

8. Remove lever components (a) from sheave (b).

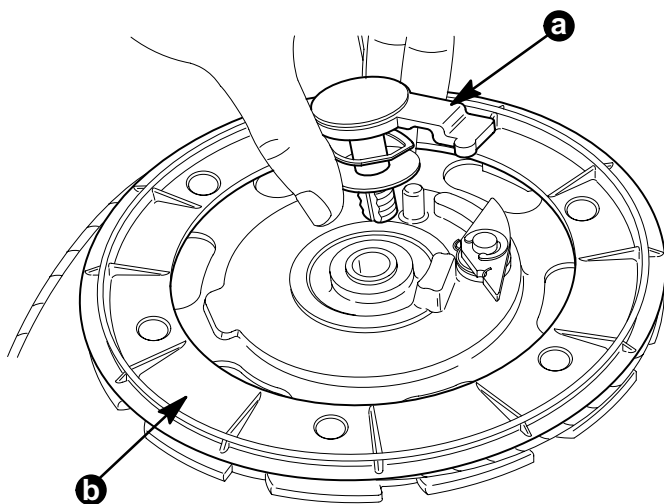

54848

9. Remove rewind spring by placing sheave over 2 pieces of wood (2 x 4's) with spring facing down. Tap top of sheave with a mallet. This will cause rewind spring to drop out of sheave.

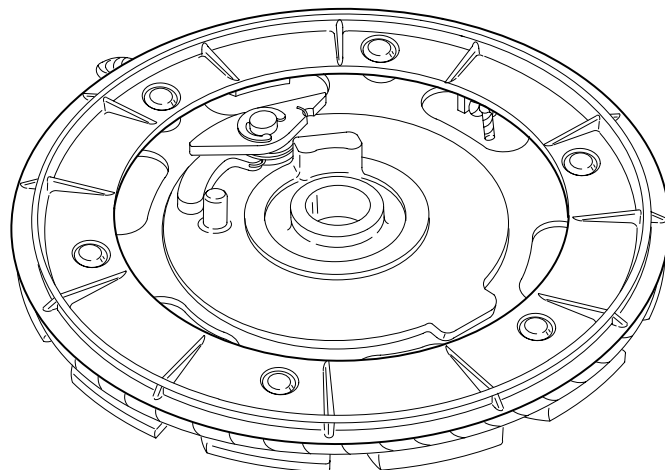

54849

Cleaning and Inspection

1. Clean components in solvent and dry with compressed air.
2. Inspect rewind spring for kinks, burrs, corrosion or breakage.
3. Inspect starter sheave, rope guide and starter housing for nicks, grooves, cracks, wear or distortion, especially area of rope travel.
4. Inspect bushing, starter drive pawl and spring for wear or damage.
5. Inspect starter rope for wear.
6. Replace components as necessary.



Rewind Starter Reassembly

⚠ WARNING

When reassembling rewind starter, **SAFETY GLASSES** must be worn in case rewind spring uncoils out of the housing.

Installing Used Rewind Spring

1. Lubricate rewind spring with low temperature grease.
2. To enable sheave to rotate when installing rewind spring, place bushing and sheave shaft into sheave. Add flat washers, below sheave to raise sheave above vise. Secure sheave shaft in vise that is equipped with soft jaw protectors.
3. Engage hook (on end of spring) into sheave.
4. Turn sheave clockwise, while feeding spring into recess, and use thumbs to guide rewind spring into recess. Proceed cautiously; do not allow spring to get out-of-control.
5. Remove sheave from vise and remove sheave shaft and bushing.

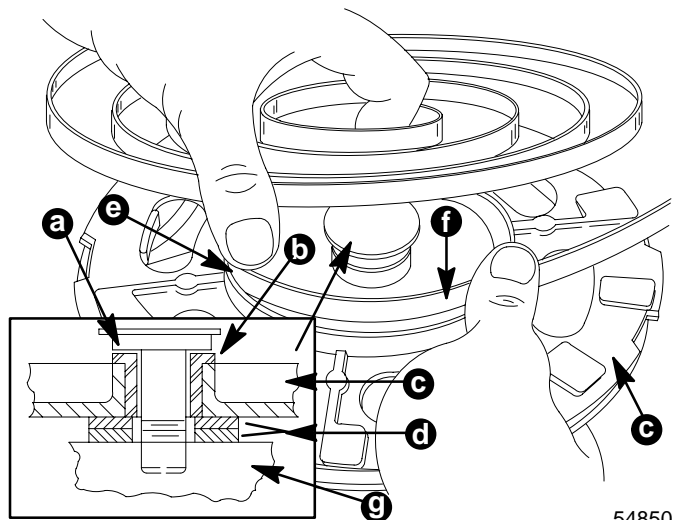

54850

- a - Sheave Shaft
- b - Bushing
- c - Sheave
- d - Flat Washers (Allowing Enough Clearance for Sheave to Rotate Above Vise)
- e - Hook Spring in Notch
- f - Turn Sheave Clockwise while Feeding Spring into recess
- g - Vise (with Soft Jaw Protectors)

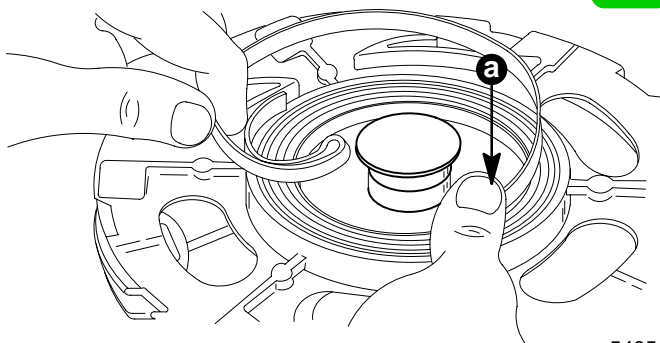

54851

- a - Push Rewind Spring into Recess while Turning Sheave Clockwise

Installing New Rewind Spring

1. Remove retainers (used to keep spring from accidentally coming out of shipping container).
2. Place hook (on end of spring) into sheave anchor and place support tabs (a) on container above spring recess, as shown.
3. Insert 2 large bit screwdrivers thru openings (b) and push spring out of shipping container and into spring recess in sheave.

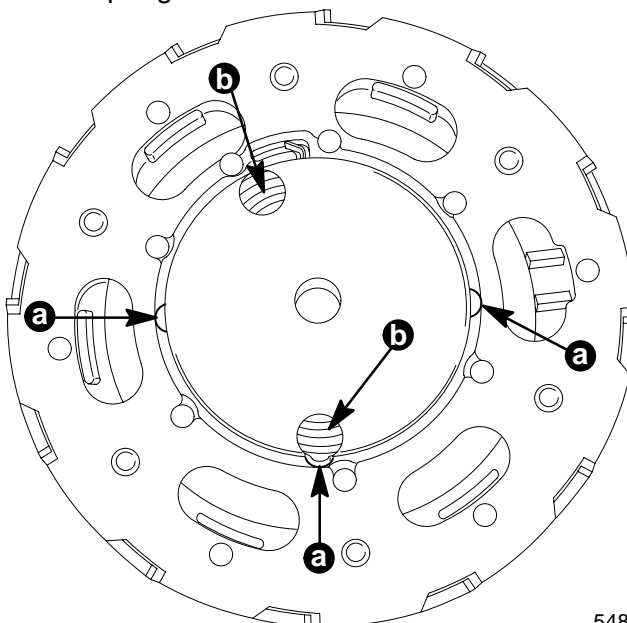

54852



Rope Installation

1. Route rope thru hole in sheave.
2. Tie a knot in end of rope and place knot in recess (a).
3. Wind rope (b) clockwise onto sheave (when viewed from rewind spring side of sheave).

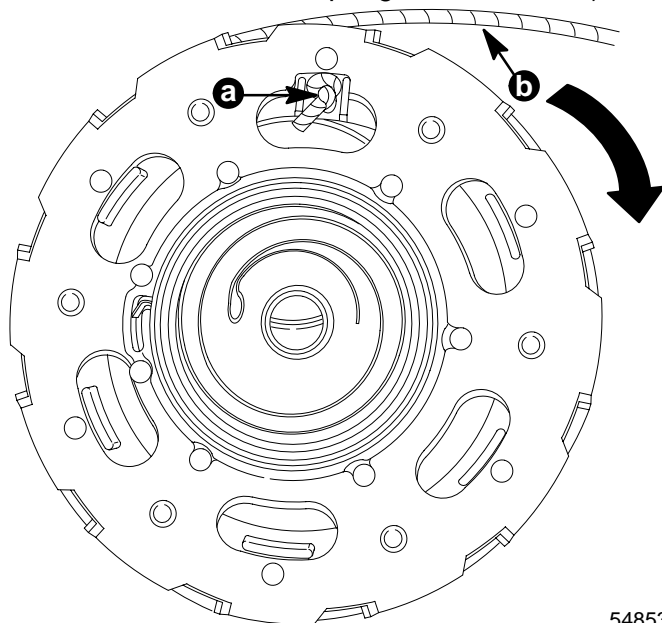

54853

4. Lubricate shoulder on sheave shaft (a) with low temperature grease and install lever as shown.

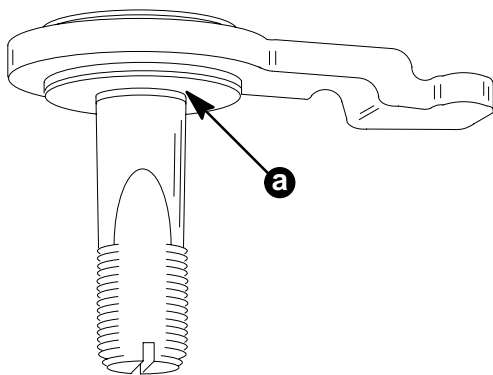

54854

5. Lubricate all components with low temperature grease.

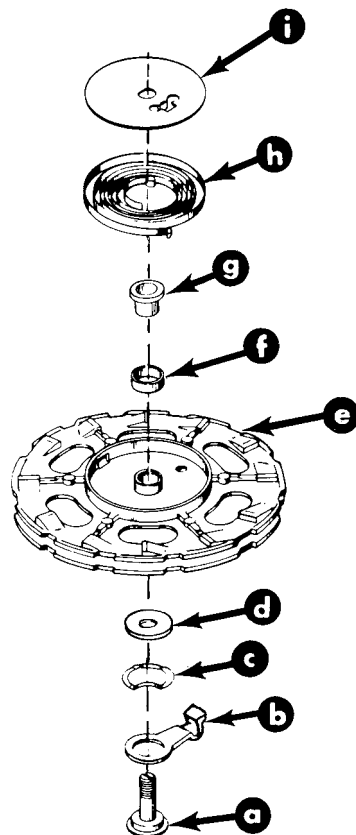

- a - Sheave Shaft
- b - Lever
- c - Wave Washer
- d - Flat Washer
- e - Sheave
- f - Spring Bushing
- g - Shaft Bushing
- h - Rewind Spring
- i - Spring Retainer Plate

6. Assemble sheave components as shown.

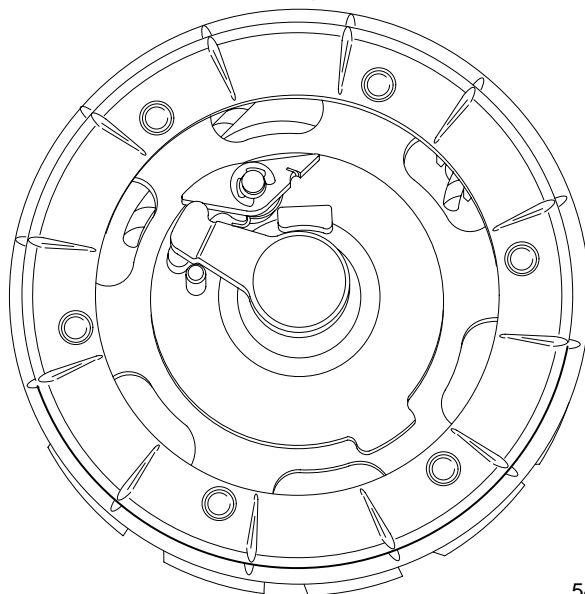

54855



7. Install spring bushing (a) and shaft bushing (b).

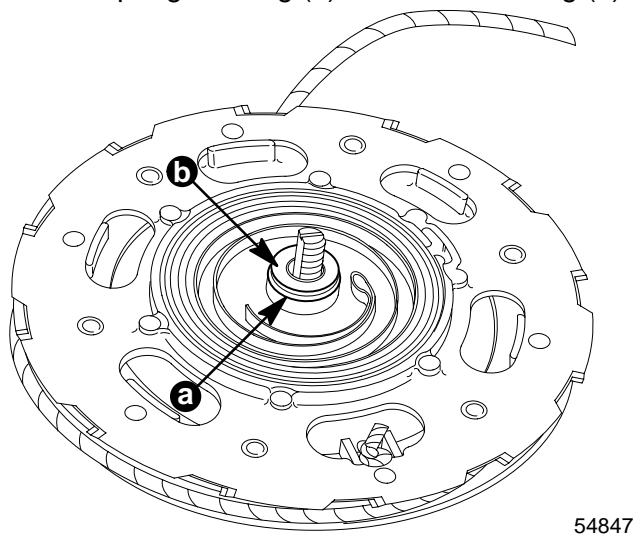

8. Install spring retainer plate (a) over sheave shaft. Use a thin shaft screwdriver to engage tab into inner loop of rewind spring.

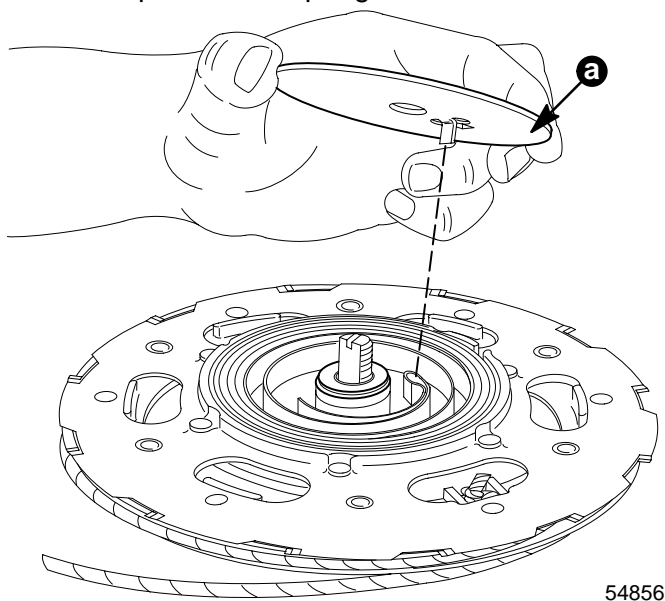

9. Spring retainer plate installed.

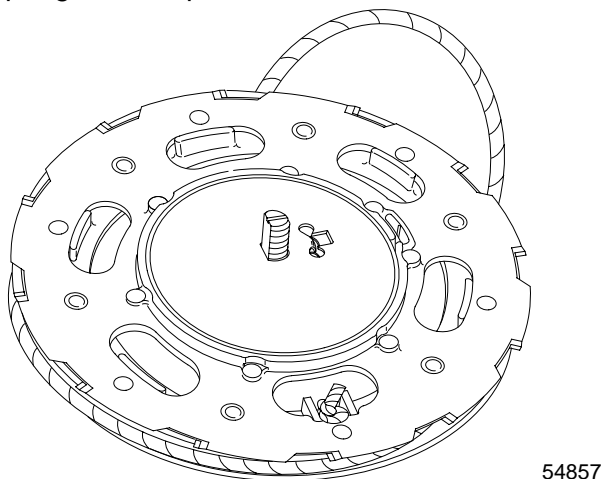

10. Push starter rope thru rope guide (a) then place sheave assembly into rewind housing.

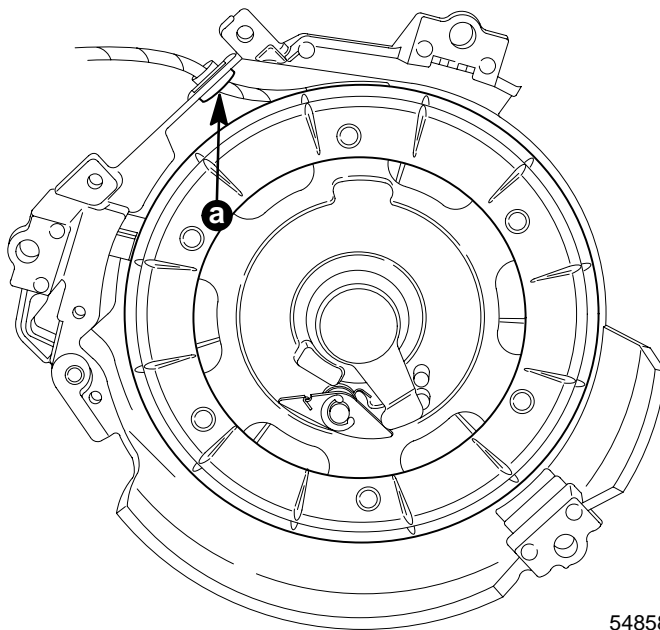

11. Place new locking tab washer ("b" cupped side facing down on sheave shaft).

12. Thread nut ("c" left hand thread) finger tight on shaft.

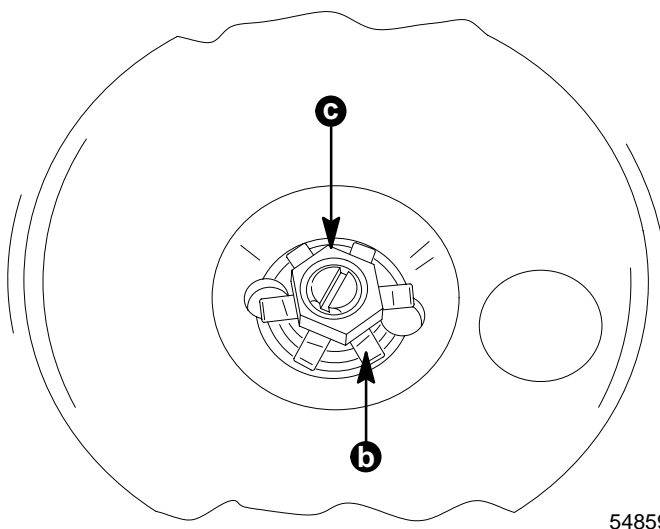



Adjusting Rewind Spring Tension

1. Tie a slip knot in starter rope approximately 12 in. (305mm) from end of rope.
2. Using a screwdriver (a) turn sheave shaft counterclockwise to pull knot in rope against rope guide.
3. With rope knot against rope guide, turn sheave shaft 2 full turns counterclockwise to add proper tension to rewind spring.
4. Position tab of tab washer over holes in rewind assembly.
5. While holding sheave shaft as described in step "2", tighten sheave shaft retaining nut (b).

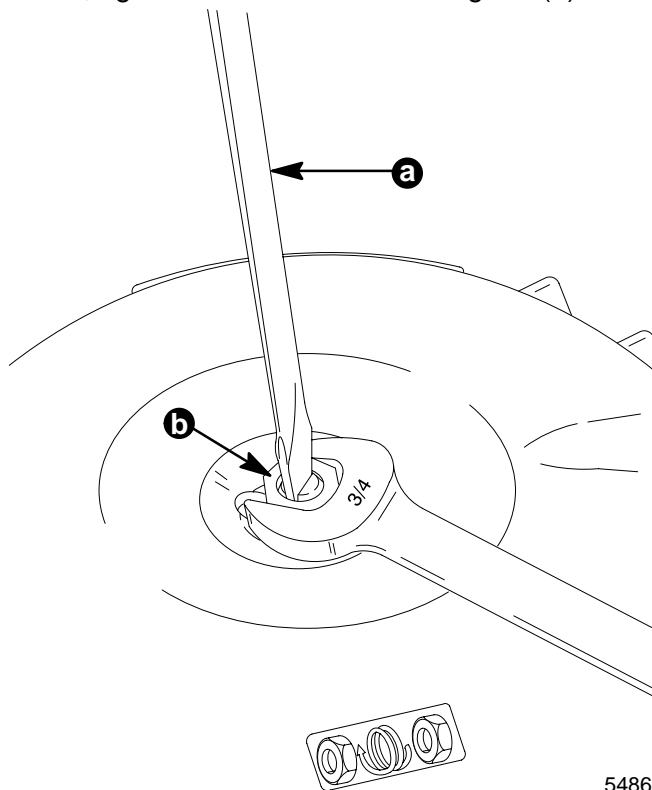

54860

- a - Hold Retainer Nut and Turn Sheave Shaft 2 Full Turns to Add Proper Tension to Rewind Spring
b - Sheave Shaft Retaining Nut (Left hand Thread - Turn Counterclockwise to Tighten)

NOTE: Check operation of rewind starter before bending tabs against nut.

6. Check rewind operation as follows:
 - a. Slowly pull starter rope outward. Pawl must move to engage position as the lever begins to turn.
 - b. Extend starter rope to full length and allow it to slowly rewind (must rewind smoothly without catching).
 - c. If starter rope catches and fails to rewind smoothly, the sheave shaft and washers are not correctly aligned.
7. Bend 2 tabs (a) of tab washer against flats of retaining nut and 2 tabs (b) into holes in rewind housing, as shown.

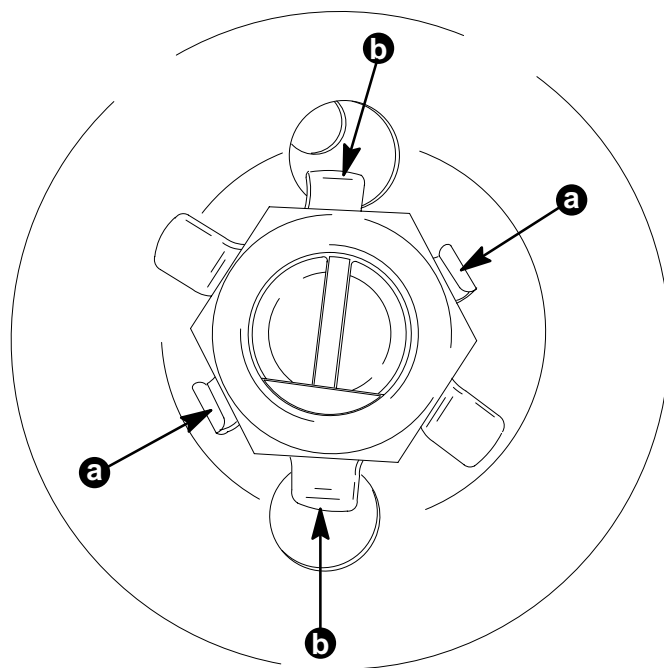

54861



8. Install rewind starter on engine with 3 screws and lockwashers. Torque to 100 lb. in. (11 N·m).
9. Install and adjust shift interlock cable as outlined in "Shift Interlock Adjustment" Section 7B.

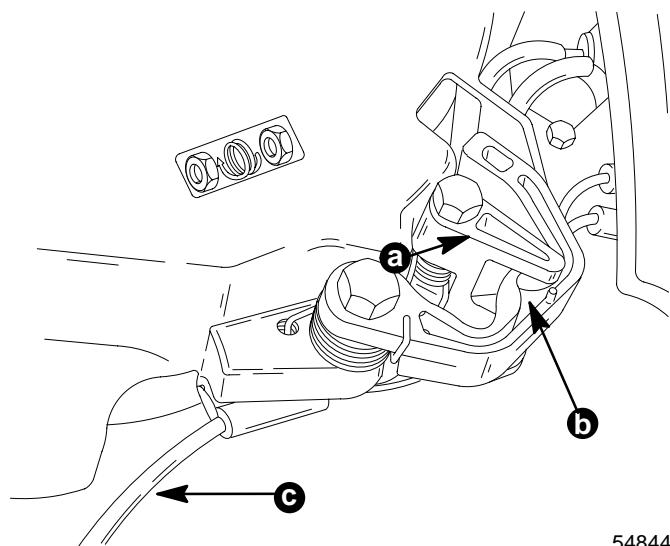

54844

- a - Interlock Actuator
- b - Interlock Cam
- c - Interlock Cable

10. Pull starter rope thru cowl panel and install handle and rope retainer.
11. Reinstall removed cowling.

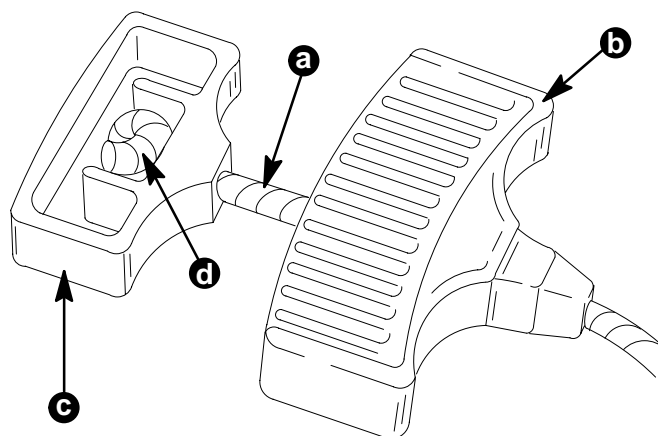

54862

- a - Starter Rope
- b - Handle
- c - Retainer
- d - Knot